

**The University of Texas School of
Dentistry at Houston**



**Exam Site Information for Candidates
Western Regional Examining Board (WREB)
2019 WREB Dental Examination**

7500 Cambridge St.
Houston, TX 77054
713-486-4002

TABLE OF CONTENTS

	<u>Page #</u>
Travel and Housing Arrangements	3
• Airline and Airport Information	3
• Ground Transportation To/From Airports	3
• Housing	4
School of Dentistry Facility and Services	4
• Building Access and Hours	4
• Parking	4
• Registration and Identification Badges	5
• ATM Machines	5
• Food Service	5
Patient Screening and Imaging	5
Preparing for the Exam	6
• Cubicles (Operatories)	6
• Equipment, Instruments and Materials	6
• Endodontics Exam	7
During the Board	8
• Infection Control	8
• Sterilization	9
• Medical Emergencies	9
Handbook Appendices	
• Exam Room Assignments	11
• Dental Supplies	12
• Maps	13

Welcome to the University of Texas Health Science Center at Houston – School of Dentistry

The School of Dentistry is located at 7500 Cambridge St. Houston, TX 77054, which is at the corner of Cambridge St. and East Rd. This handbook has been prepared to assist dental candidates for the Western Regional Examination Board Exam. If additional information is needed after reading this handbook, please contact the Office of the Associate Dean for Patient Care at (713) 486-4002 or send email to Dorothy.roberts-goff@uth.tmc.edu.

Travel and Housing Arrangements

1. **Airline and Airport Information**

Houston is served by two airports: Hobby Airport in Southeast Houston and George Bush Intercontinental Airport of Houston (IAH) in North Houston. Depending on origination, candidates may find flights into both airports and should inquire when booking reservations. Being the larger airport, Bush Intercontinental accommodates a larger number of airlines and flights.

2. **Ground Transportation to/From Airports**

In non-rush hour periods, expect a minimum drive time of approximately 35 minutes from Hobby and approximately 55 minutes from Bush Intercontinental. Candidates have three (3) primary choices for ground transportation from Houston's airports:

a. **Shuttle bus**

Texas Bus Lines (713-523-8888) operates the Airport Express Shuttle Service to/from both airports. Shuttle service is provided at the Marriott Medical Center and the Holiday Inn Hotel & Suites. Please call for fares.

b. **Taxi cab**

While several companies serve Houston, candidates may elect to use one of the following and should call for approximate fares:

Liberty Cab	(713) 364-4977
United Cab	(713) 699-0000
Yellow Cab	(713) 236-1111

c. **Rental car**

Both Houston airports are served by all major car rental companies. Those listed below are just a few that are available:

Alamo Rent-A-Car	(800) 327-9633
Avis Rent-A-Car	(800) 331-1221
Hertz Rent-a-Car	(800) 654-3131
National Car Rental	(800) 227-7368
Thrifty Car Rental	(800) 367-2277

d. Directions for Driving from Airports and Freeways

From Bush Intercontinental Airport - Depart Intercontinental Airport onto Will Clayton Boulevard. Take Will Clayton to Highway 59 South. Travel Highway 59 South to Highway 288 (19 miles). Exit Holcombe Blvd. Stay straight and take a right on Old Spanish Trail. Turn left onto Cambridge St. Take the first right onto East Rd. The School of Dentistry is located at the corner of Cambridge St. and East Rd.

From Hobby Airport - Depart Hobby Airport onto Broadway. Travel Broadway to I-45 North. Take I-45 North to 610 Loop West. Follow 610 Loop West towards 288 and exit Yellowstone Blvd. Stay straight and turn left on Old Spanish Trail. Turn left onto Cambridge St. Take the first right onto East Rd. The School of Dentistry is located at the corner of Cambridge St. and East Rd.

3. Housing

Reservations should be made directly with hotels/motels, and accommodations located within a few blocks of the school are listed below. Candidates should call for rates.

Residence Inn 7710 South Main Houston, Texas 77030 (713) 660-7993	Hampton Inn & Suites 1715 Old Spanish Trail Houston, Texas 77054 (713) 797-0040	Holiday Inn Hotel & Suites Medical Center 6800 Main Street Houston, Texas 77030 (713) 528-7744
--	--	--

NOTE: All hotels/motels listed above may provide courtesy transportation to the School of Dentistry Texas.

School of Dentistry Facility and Services

1. Building and Bookstore Access Hours

The School of Dentistry building will be open from 6:00 a.m. to 6:00 p.m. during the Western Regional Board Examination, unless otherwise requested by the examiners. The school Bookstore (Room 2202 on the 2nd floor) will also be open from 7 am to 5 pm on Wednesday, Thursday, and Friday of the WREB. It will be closed on Saturday.

2. How to Access Security

A security desk is located in the main lobby on the 1st floor.

3. Parking

Parking is located directly across the street from the School of Dentistry. The rate as of 9/20/18 is hourly with a \$10.00 maximum daily fee. Parking can be paid at the exit by credit card.

4. Registration and Identification Badges

Numbered badges will be issued to candidates at candidate orientation and will serve as an I.D. throughout the examination. The badge must be worn at all times while in the building. Badges must be turned in at the completion of the examination as part of the check-out procedure with the Western Regional Examining Board.

5. **Food Service**

The School of Dentistry has a “Grab and Go” located on the first floor room 1202. Food and beverage machines are located on the first floor as well.

Patient Screening

The School of Dentistry **cannot** provide patients for candidates. Candidates should not ask the school for patients or patient records. Candidates may use the School of Dentistry to screen patients on a limited basis. Screenings are to be performed in the school’s Assessment Clinic, located on the first floor. Please note the available dates and times below.

Monday May 6th from 9:00 am until 11:00 am and from 1:00 pm – 3:00 pm on and Tuesday May 7th from 9:00 am until 11:00 am and 1:00 pm- 3:00pm.

There will be no screenings during the WREB exam.

** Patient brokering, i.e. the selling of patients, will not be tolerated under any circumstances within the school of dentistry and/or on the premises of the university. Violation of this rule will result in immediate removal from the campus of the university.*

School of Dentistry Imaging (Radiology) Policy

This site will be a digital facility only.

Preoperative radiographs for up to two (2) operative procedures for Provisional Acceptance can be submitted as outlined below.

Submitting Radiographs

Radiographs will be uploaded to WREB’s secure website by a designated staff member at UTSD. Uploads can only be done by the designated staff member(s) during the assigned window which is April 3-18, 2019. Once the window has closed, no additional radiographs will be accepted for Provisional Acceptance. If you do not submit during the window, you will submit your patient(s) in the traditional manner at the clinical exam site.

You may upload two (2) submissions. Once a procedure is submitted, no changes will be allowed. You can send your images, in the correct format as specified in the Candidate Guide to Dorothy.Roberts-Goff@uth.tmc.edu

Candidates are solely responsible for providing diagnostic quality radiographs, correct tooth numbers, and a diagnosis of the restorative procedures for all qualifying lesions on the teeth submitted for acceptance.

Imaging Clinic

The Imaging Department is located on the first floor adjacent to the patient waiting area.

Since our facility's radiography is completely digital, all outside candidates will need to bring your enhanced digital radiographs in a printout form. All radiographs must be on high quality photographic paper.

It is strongly recommended that candidates have radiographs taken before arriving at the School of Dentistry. However, screenings can be performed in the School of Dentistry Assessment Clinic on the first floor during the times listed above.

Any radiographs obtained on a potential patient require the written authorization of a School of Dentistry Faculty member(s) assigned to the area. The *Radiograph Authorization Assessment Form* is available in the Assessment clinic.

Candidates using the Radiology Clinic are required to follow School of Dentistry infection control policy and to wear proper clinic attire. Staff will not be available to take radiographs. XCP and BW/XCP as well as phosphor plates will be provided. Candidates will be responsible for exposing and scanning their patient's PSP (phosphor plate).

The clinic will be available on the following dates and times prior to the exam.

Monday May 6th from 9:00 am until 11:00 am and from 1:00 pm – 3:00 pm on and Tuesday May 7th from 9:00 am until 11:00 am and 1:00 pm-3:00 pm.

The Imaging Clinic will be available to the candidates and their assistants during the exam on a limited basis (emergency situations only) from 7:30 am – 5:00 pm. Again, please note that the school will accommodate digital radiography only.

Supplies available in Radiology Clinic:

Cotton rolls
Bitewing tabs
Disposable foam Stabe biteblocks
Gowns
Facemask
Sanitizing materials
Latex free gloves
Phosphor plates
XCP's
Film cushions

Preparing for the Exam

1. Cubicles (Operatories)

Each candidate will be assigned a numbered cubicle in the clinic which will correspond to the applicant's numbered I.D. badge issued at orientation. Each cubicle is equipped with one (1) dental chair (Adec), one (1) delivery unit equipped with an air/water syringe (Adec), and one (1)

operator's stool. Any equipment malfunctions should be reported to The Office of Patient Care 713-486-4002 room 3510.

2. Equipment, Instruments and Materials

Items to be supplied by candidates and the School of Dentistry are included in the supplements at the end of this handbook (page 11). **Anything not listed the candidate must provide.**

***There are no instruments and equipment available for rental to candidates.**

a. Handpiece Hookups

Each 12 O'clock delivery unit is equipped with one 6-pin air tubing, one electric motor, and one Satelec Newtron Piezo handpiece tubing (**no handpiece**).



12 O'Clock Delivery Unit



6-Pin Tube with W&H RQ-24 (removable)



Acteon Newtron Piezo Handpiece Tube



Electric Motor
Will not work w/some Bien Air or Kavo attachments

b. Ultrasonic Scaler Hookups

All dental units have quick-connector water sources. The names of some scaler units adaptable to the school's quick connector with 1/4" fitting are:

- Cavitron (Dentsply)
- Densonic Scaler (Dentsply)
- Schein
- Titan – Star

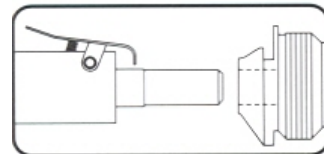

****There are no handpieces available for rental to candidates.**

3. Endodontics/Prosthodontic Exam

The laboratory will be equipped with manikin assemblies. Facial shrouds will not be used. The endodontic and prosthodontic modules will be attached to the typodont base with a screw mount. For specifics on models to be used please refer to the 2019 Candidate Guide or Acidental's website at www.acidental.com/WREB.

Materials provided in the Endo/Pros Lab

<ul style="list-style-type: none">• Cups• Rubber Dam• Cotton Pellets• Cotton Rolls• Cotton Tips• RC-Prep (EDTA)• Tongue Depressors• Gowns	<ul style="list-style-type: none">• Alcohol 2x2's• Gutta-Percha• Paper Mixing Pads• Floss• Gloves• EDTA Solution• AH Plus• Opti-X w/2mm Sphere• Weigh Dish	<ul style="list-style-type: none">• Mannequin• Endo Gas Burners• Napkins• Syringe• X-Ray Machine• Paper Points• 2x2 Gauze• Surgical Tips• PVS putty material
--	--	--

***Please note: There is no internal lab available for casting and the school does not use any outside labs, if this is something that you require, please do any research or make arrangements prior to your arrival.**

During the Board

1. Infection Control

a. Surface Asepsis

- Handles of the unit light, x-ray heads, light cure units, and air-water syringes may be covered with either clear plastic wrap or blue adhesive backed plastic wrap.
- The patient chair, dental unit, and counter tops may be disinfected by using disinfectant wipes.
- Plastic head rest covers and plastic wrap are provided. Disinfectant wipes and barrier bags are available on each floor.
- Candidates must furnish their own utility gloves to be worn during scrub and handling of dirty instruments.

b. Personal Protective Equipment

- Appropriate protective clothing, including disposable gowns, are available and must be worn in occupational exposure situations.
- Disposable gloves, masks and gowns are located at each clinical dispensary.
- Candidates are to provide their own OSHA-acceptable protective glasses. Chlorhexidine antiseptic soap is available at sinks in all clinics.

c. **Hazardous Waste**

- Any blood/saliva-soaked waste is considered hazardous and must be disposed of in biohazard bags available at the clinical dispensary.
- Biohazard bags may be attached to the sides of the bracket tray. At the end of each session, bags should be sealed and placed in biohazard waste containers which are located at the dispensary

d. **Sharps Disposal**

All needles, anesthetic cartridges, and any potential sharps are to be placed in the plastic sharps containers located in each cubicle.

2. **Sterilization**

Instruments and handpieces properly cleaned, dried, wrapped and marked with appropriate candidate I.D. # will be accepted for steam sterilization at the second floor clinical dispensary, Room 2520. Sterilization services are available from 8:00 a.m. to 12:00 noon and from 1:00 p.m. to 4:00 p.m. on Monday, May 6, 2019 through Wednesday, May 8, 2019 and From 7:00 a.m. to 5:30 p.m. Thursday, May 9, 2019 through Saturday May 11, 2019. Instruments received after 3:30 p.m. will not be ready until 7:30 a.m. the following day.

3. **Medical Emergencies (“Code Blue”)**

In order to alert emergency personnel to a medical emergency and not unduly alarm the patient population, the following protocol must be followed upon discovering a serious medical emergency:

- a. The patient will remain in the care of the candidate or person discovering the problem. **The patient must not be left alone.** The assistant or responsible person will be sent to report the problem to the floor Examiner.
- b. The Floor Examiner will make a judgment as to whether a “coded” emergency exists.
- c. The assistant will be sent to the nearest dispensary for an emergency crash cart with a request that the dispensary place an immediate call for a “Code Blue” announcement.
 1. If a “coded” emergency has been declared, dispensary personnel will provide the emergency crash cart for the messenger and immediately place calls to the following locations:

Office of Clinical Services (SOD 3210) Dial 486-8873
Office of Patient Care (SOD 3510) Dial 486-4002

The message should be stated clearly and briefly as follows:

“Code Blue in progress on _____ floor, _____ area.”

2. If nursing assistance only is requested, dispensary personnel will immediately notify the Office of Clinical Services, 486-8873.
-
- d. In all possible emergencies:
 - Place the patient in a supine position, if unconscious
 - Assess consciousness and responsiveness
 - Check airway, assist respiration if indicated
 - Check pulse, be prepared to perform CPR if indicated

 - e. Emergency carts are located in all clinical dispensaries, the Special Patient Clinic (Area A), Periodontal Graduate Clinic (Area K) and the Oral and Maxillofacial Surgery Clinic (Area D). A floor RN with a crash cart and emergency personnel will go to the area of the emergency on a “Code Blue”. Emergency manuals are located on the crash carts.

 - f. The examiner assumes responsibility for resuscitative procedure and the administration of emergency drugs until relieved by other personnel. Emergency manuals are located on the crash cart.

EXAM ROOM ASSIGNMENTS

Schedule* and Locations

	<u>Room #</u>
Wednesday May 8, 2019	
Candidate Orientation	4310
School Tour	4310
Thursday May 9 thru Friday May 10, 2019	
Clinic Exam Area (2 nd floor)	Bays: H & J
(Left-handed cubicles to be designated by WREB)	
Endodontic-Pros Lab Exam (Simulation Center)	3460
Saturday May 11, 2019	
Clinic Exam Area (2 nd floor)	Bays: H & J
Endodontic –Pros Lab Exam (Simulation Center)	3460
<u>Other Important Rooms</u>	
Clinical Dispensary/Central Sterilization Receiving	2520

*See official WREB documents for times.

DENTAL SUPPLIES

Items Supplied by Clinical Dispensary (items not listed are the responsibility of the applicant):

<ul style="list-style-type: none"> • Air/Water Syringe Tip, Disposable • Amalgam Capsules • Anesthesia, Local & Topical • Articulating Paper • Bags, Biohazard • Bags, Sterilization • Bags, Trash • Integrity Temp Grip • Cement, Permanent (Duralon, Rely-X Unicem, Rely X-Luting Cement, Rely X-Veneer Cement, Variolink II,) • Composites (Z250) • Cotton Gauze - 2x2 Sponges • Cotton Pellets • Cotton Rolls • Cotton Swabs • Crowns, Temporary • Crown Formers (Ellman's, Integrity) • Cups, Drinking • Disinfectant Wipes (PDI AF3) • Thera Cal LC • Evacuator Tips • Face Masks • Facial Tissue • Floss • Glass Ionomer – Fuji II LC • Gloves-nitrile • Headrest Covers • Impression Material • Impression Trays, Disposable • Mouthwash • Napkins, Patient 	<ul style="list-style-type: none"> • Needles, short and long • Paper Towels • Plastic Wrap • Polishing Materials for Restorations • Prophy Paste • Pulp Testers • Retraction Cord • Rubber Dam & Napkins • Saliva Ejectors, standard • Soap, Hand • Instrument Trays • Temporary Filling Materials (Cavit, Cavit- G, Systemp, IRM) • Tray Cover • Air/Water Syringe w/Hub (on chair) • Face masks • Gloves • Gowns • Isopropyl Alcohol Pads
--	---

Please Note: Candidates must provide their own files

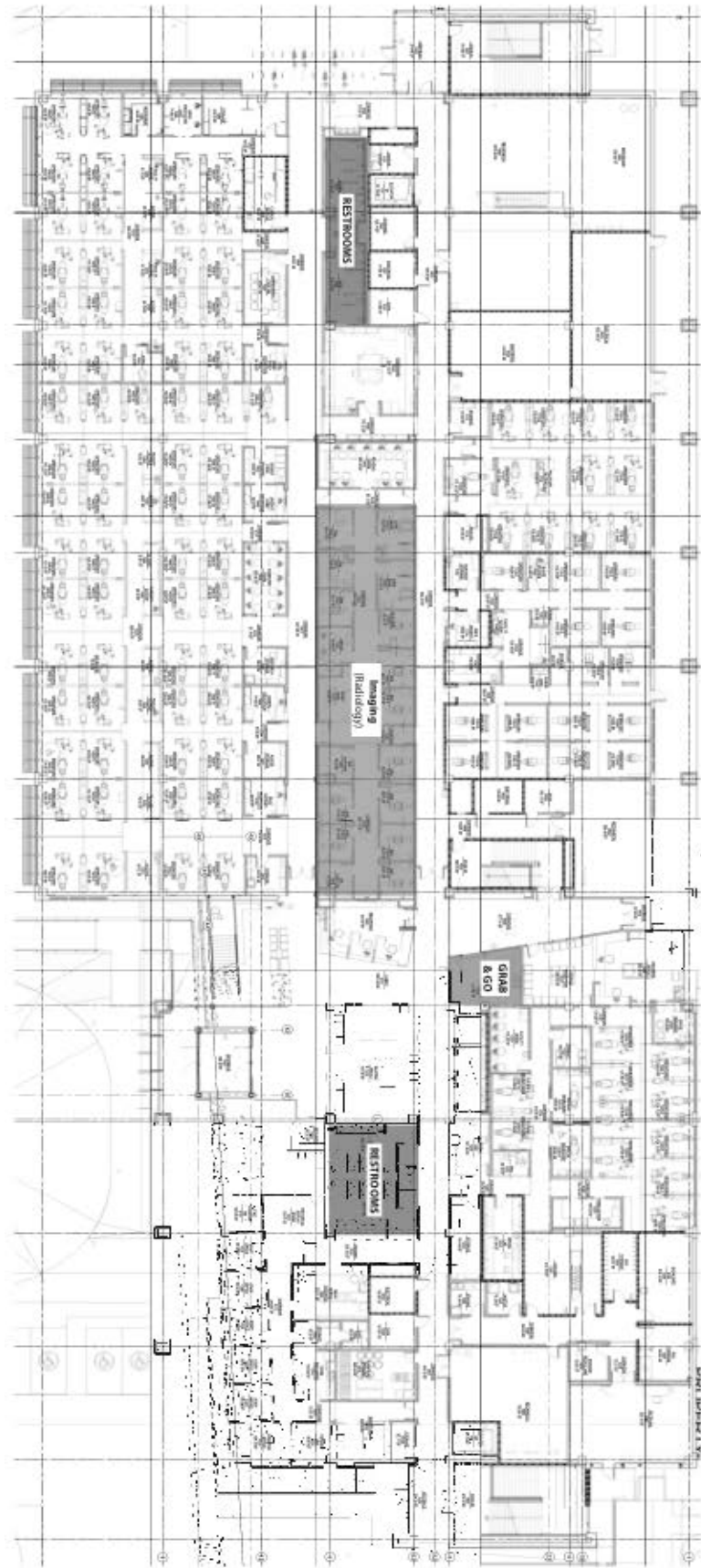

West

First Floor

East

